



137 Billinge Road, Wigan

£130,000 Leasehold

- In need of some modernisation
- End terraced house
- Lounge & kitchen
- Downstairs WC
- Small utility space
- Large shower room
- Rear yard (space for parking)
- Parking available to the rear of the property for three cars
- Shared ownership on the garden to the side
- EPC E

Council Tax band: A

Tenure: Leasehold

EPC Energy Efficiency Rating: E

EPC Environmental Impact Rating:



- › In need of some modernisation
- › End terraced house
- › Lounge & kitchen
- › Downstairs WC
- › Small utility space
- › Large shower room
- › Rear yard (space for parking)
- › Parking available to the rear of the property for three cars
- › Shared ownership on the garden to the side
- › EPC E





Approx Gross Internal Area
76 sq m / 823 sq ft

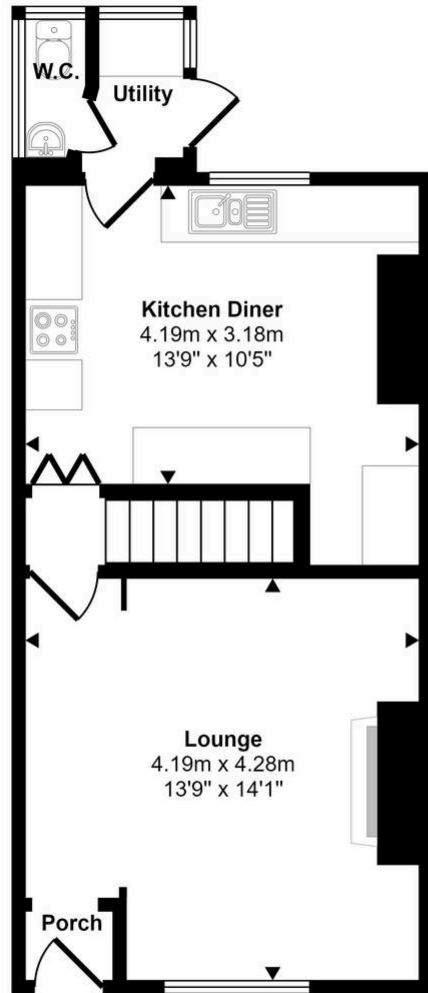

Ground Floor
Approx 40 sq m / 427 sq ft

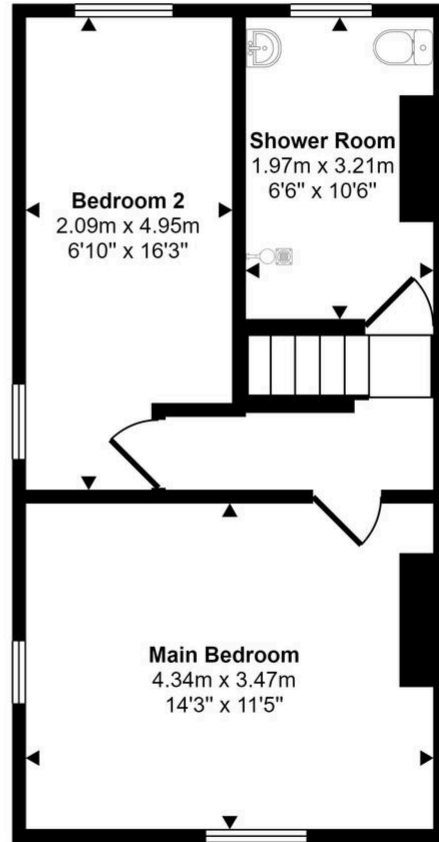

First Floor
Approx 37 sq m / 396 sq ft

This floorplan is only for illustrative purposes and is not to scale. Measurements of rooms, doors, windows, and any items are approximate and no responsibility is taken for any error, omission or mis-statement. Icons of items such as bathroom suites are representations only and may not look like the real items. Made with Made Snappy 360.

You can include any text here. The text can be modified upon generating your brochure.