



## 16 Chelmsford Mews, Wigan

£150,000 Leasehold

Two double bedrooms • Ground floor apartment • Popular location • Well presented throughout • Gated entrance and a parking space • Walking distance to Wigan town centre • Leasehold/ council tax bad C • EPC-D

Well-presented ground floor flat in Swinley, Wigan. Two double bedrooms, lounge/diner, fitted kitchen, gated parking, secure entry. Walk to Mesnes Park and town centre.

Council Tax band: C

Tenure: Leasehold

EPC Energy Efficiency Rating: D

EPC Environmental Impact Rating: C



- Two double bedrooms
- Ground floor apartment
- Popular location
- Well presented throughout
- Gated entrance and a parking space
- Walking distance to Wigan town centre
- Leasehold/ council tax bad C
- EPC-D





Approx Gross Internal Area  
58 sq m / 629 sq ft

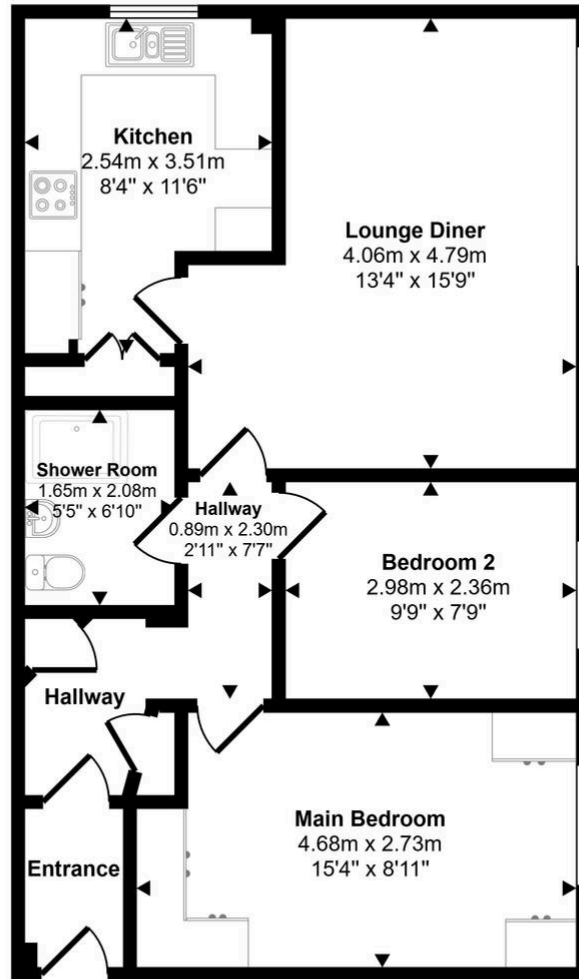

Floorplan

This floorplan is only for illustrative purposes and is not to scale. Measurements of rooms, doors, windows, and any items are approximate and no responsibility is taken for any error, omission or mis-statement. Icons of items such as bathroom suites are representations only and may not look like the real items. Made with Made Snappy 360.

You can include any text here. The text can be modified upon generating your brochure.