



27 Tontine, Orrell

£200,000 Freehold

Characterful cottage dating back to 1788 • Cosy lounge with wood-burning stove • Spacious country-style kitchen with dining area • Two well-proportioned bedrooms • Large upstairs bathroom with bath and separate shower • Private rear garden with patio and lawn • Charming period features throughout • Street parking available • Freehold

Charming 1788 cottage with lounge, wood-burning stove, spacious kitchen, two bright bedrooms, modern bathroom, street parking, and a refreshed rear garden with patio and lawn.

Council Tax band: TBD

Tenure: Freehold

EPC Energy Efficiency Rating: E

EPC Environmental Impact Rating: E



- Characterful cottage dating back to 1788
- Cosy lounge with wood-burning stove
- Spacious country-style kitchen with dining area
- Two well-proportioned bedrooms
- Large upstairs bathroom with bath and separate shower
- Private rear garden with patio and lawn
- Charming period features throughout
- Street parking available
- Freehold





Approx Gross Internal Area
82 sq m / 881 sq ft

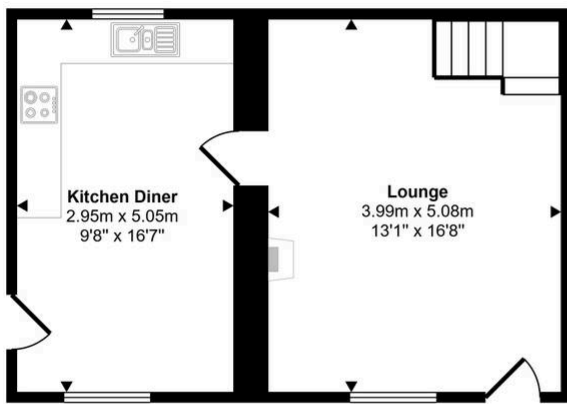

Ground Floor
Approx 38 sq m / 405 sq ft

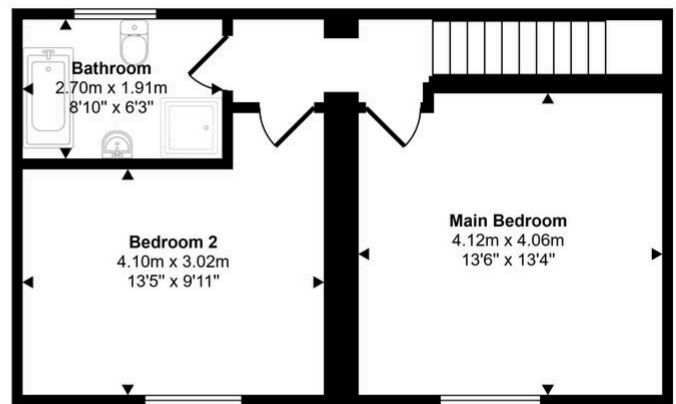

First Floor
Approx 44 sq m / 476 sq ft

This floorplan is only for illustrative purposes and is not to scale. Measurements of rooms, doors, windows, and any items are approximate and no responsibility is taken for any error, omission or mis-statement. Icons of items such as bathroom suites are representations only and may not look like the real items. Made with Made Snappy 360.

You can include any text here. The text can be modified upon generating your brochure.